

6GHz DIN 1.0 / 2.3 Coaxial Connectors

Dual Port Connector System for PCI Express® Applications

Part Number C-SX-143

General Description

The C-SX-143 is a low profile dual port connector which allows an enhanced packing density of connections on a standard PCI Card. This is made possible by combining the small format of DIN 1.0 / 2.3 style connectors with a unique diagonal mounting style, while also offering the standard of SMPTE ST 2081-1 , allowing bit-rates of 5.94Gbit/s over a single coaxial connection.

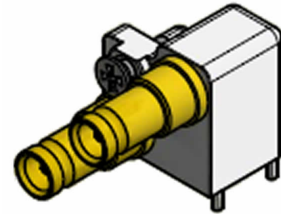

Electrical Specification

Impedance:	75Ω
Frequency Range:	0-6GHz
Working Voltage:	250Vrms
Dielectric Withstanding Voltage:	750Vrms
Reflection Factor (VSWR):	1.15 ^(max) DC - 3GHz 1.36 ^(max) 3 - 6GHz
Contact Resistance:	Centre contact 4.0mΩ Outer contact 2.5mΩ
Insulation Resistance:	>1000M Ω
Connector Type:	Female
Materials	
Centre Pin:	BeCu / 10 μ" Au
Metal Parts:	Brass / Au Zinc Alloy / Au
Insulators:	PTFE
Environmental	
Temp Range:	-65 to +85°C
Mating Cycles:	500
Processing	
Maximum wave and hand soldering temperature	265°C

Features

- Provide low profile connector array for PCI Express® systems
- Meets SMPTE ST 2081-1 Standard
- Robust push / pull latching system
- Compatible with standard DIN 1.0 / 2.3 connectors

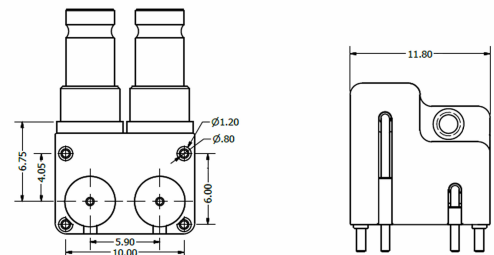
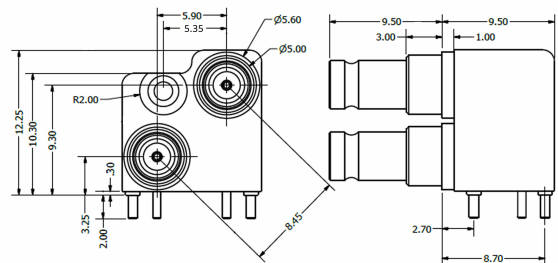

S-Parameters [Magnitude in dB]

