

6GHz DIN 1.0 / 2.3 Coaxial Connectors

PCB Right Angle Bulkhead Connector for PCI Express® Applications

Part Number C-SX-148

General Description

The C-SX-148 precision 75Ω 1.0/2.3 Connector is a right angle PCB mounted bulkhead connector with short legs for PCI Express Applications. This range of connectors meets the SMPTE ST-2081 standard and is ideal for use in industrial process control and data acquisition applications. The connector is supplied with nut.

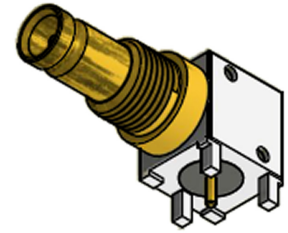

Electrical Specification

Impedance:	75Ω
Frequency Range:	0-6GHz
Working Voltage:	250Vrms
Dielectric Withstanding Voltage:	750Vrms
Reflection Factor (VSWR):	1.13 ^(max) DC - 3.0GHz 1.29 ^(max) 3.0 - 6.0GHz
Contact Resistance:	Centre contact 4.0mΩ Outer contact 2.5mΩ
Insulation Resistance:	>1000M Ω
Connector Type:	Female

Features

- Meets SMPTE ST-2081 Standard
- For PCI Express® Applications
- Optimised for 6G HD-SDI

Materials

Centre Pin:	BeCu / 10 μ" Au
Metal Parts:	Brass / Ni / Au
Insulators:	PTFE

Environmental

Temp Range:	-65 to +85°C
Mating Cycles	500

Processing

Maximum wave and hand soldering temperature 265°C

