

# 6GHz BNC Coaxial Connectors

## Bulkhead BNC Connector for PCI® Express Applications

### Part Number C-SX-156

#### General Description

The C-SX-156 is a bulkhead mounting BNC connector which can be used in PCI® Express applications. It features a pathfinder™ light pipe which aids port identification and status. The connector has a shorter leg length of 2.2mm. It also has a built in flange which provides additional EMI shielding and is optimised for 6G HD-SDI environments. The connector is not supplied with nut and washer.

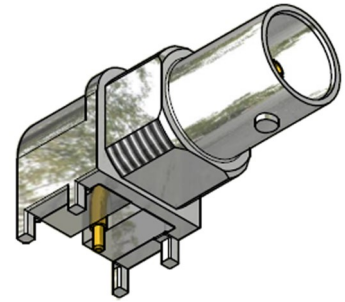

#### Electrical Specification

Impedance:	75Ω
Frequency Range:	0-6GHz
Working Voltage:	500Vrms
Dielectric Withstanding Voltage:	1500Vrms
Reflection Factor (VSWR):	1.16 <sup>(max)</sup> DC - 3GHz 1.49 <sup>(max)</sup> 3 - 6GHz
Contact Resistance:	Centre contact 1.5mΩ Outer contact 1.0mΩ
Insulation Resistance:	>5000M Ω
Connector Type:	Female
Materials	
Centre Pin:	Phosphor Bronze / 10 μ" Au
Metal Parts:	Die Cast Zinc / Ni
Insulators:	UL94 HB TPX
Environmental	
Temp Range:	-65 to +85°C
Mating Cycles:	500
Processing	
Maximum wave and hand soldering temperature	265°C

#### Features

- Bulkhead mounting for PCI® Express applications
- Incorporates Pathfinder™ Light Pipe Features
- Optimised for 6G HD-SDI Environments
- Built in flange provides EMI shielding

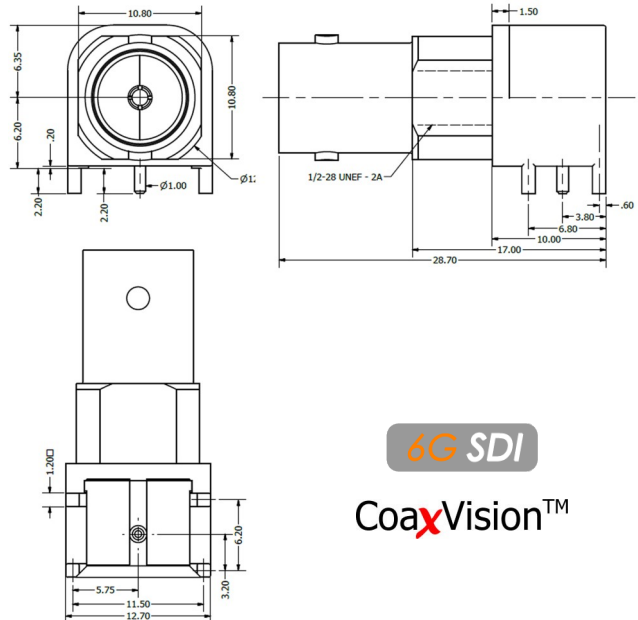

6G SDI

CoaxVision™

