

6GHz DIN 1.0 / 2.3 Coaxial Connectors

Dual Port Right Angle PCB mounted Bulkhead Connector

Part Number C-SX-167G

General Description

The C-SX-167G precision 75Ω 1.0/2.3 dual port right angle PCB mounted Connector is designed for Multi Layer PCB applications which require a longer leg length of 4.2mm. The connector is supplied with nuts.

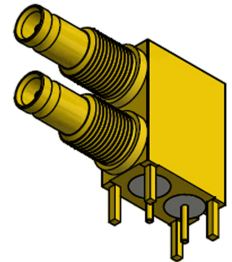

Electrical Specification

Impedance:	75Ω
Frequency Range:	0-6GHz
Working Voltage:	250Vrms
Dielectric Withstanding Voltage:	750Vrms
Reflection Factor (VSWR):	1.07 ^(max) DC - 1.5GHz 1.14 ^(max) 1.5 - 3.0GHz 1.16 ^(max) 3.0 - 3.2GHz 1.31 ^(max) 3.2 - 6.0GHz
Contact Resistance:	Centre contact 4.0mΩ Outer contact 2.5mΩ
Insulation Resistance:	>1000M Ω
Connector Type:	Female

Features

- Meets SMTPE ST-2081 Standard
- Optimised for 6G HD-SDI
- Longer leg length of 4.2mm
- For multi layer PCB applications

Materials

Centre Pin:	BeCu / 10 μ" Au
Metal Parts:	Brass / Au
Insulators:	PTFE

Environmental

Temp Range:	-65 to +85°C
Mating Cycles	500

Processing

Maximum wave and hand soldering temperature 265°C

