

6GHz Coaxial Adaptors

DIN 1.0/2.3 Female To Female Adaptor

Part Number C-SX-191

General Description

The C-SX-191 is a DIN 1.0/2.3 female bulkhead to DIN 1.0/2.3 female adaptor. This is a precision 75Ω adaptor which is suitable for frequencies up to 6GHz.. Each adaptor is supplied with a circular nut.

Features

- Precision 75Ω adaptor range
- DIN 1.0/2.3 Female to Female adaptor
- 6G-SDI compatible

Electrical Specification

Impedance:	75Ω
Frequency Range:	0-6GHz
Working Voltage:	250Vrms
Dielectric Withstanding Voltage:	750Vrms
Reflection Factor ^(VSWR) :	1.17 ^(max) 0 - 6.25GHz
Insulation Resistance:	>1000M Ω
Connector Type:	Female to Female

Materials

Centre Pin:	BeCu / 10 μ" Au
Metal Parts:	Brass / Au or Ni
Insulators:	PTFE

Environmental

Temp Range:	-65 to +85°C
Mating Cycles:	500

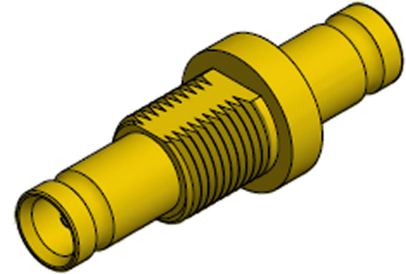

6G SDI
CoaxVision™

