

General Description

The XGS-06-EB16-NN is a low profile PCB edge mounted connector which conforms to the standard of SMPTE ST 2081-1, allowing bit-rates of 5.94bit/s over a single coaxial connection. The 8mm pitch of the connector enables high wiring densities and is optimised for use in 6G HD-SDI applications. The connector is nickel plated, but can also be purchased as a gold plated option and is for a PCB thickness of 1.6mm.

This connector was formerly sold as:
C-SX-127N when supplied with ANG-C2-BBN-2.35



Electrical

Impedance	75Ω	
Frequency Range	0-6GHz	
Working Voltage	250Vrms	
Reflection Factor (VSWR)	1.10 (max) 0-3GHz 1.32 (max) 3-6GHz	
Dielectric Withstanding Voltage	750Vrms	
Insulation Resistance	≥1000MΩ	
Contact Resistance	Centre Contact	≤ 4.0mΩ
	Outer Contact	≤ 2.5mΩ

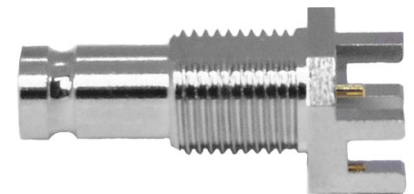

Materials

Centre Pin	BeCu / 10 μ"Au
Metal Parts	Brass/Ni
Insulators	PTFE

Environmental

Connector Type	DIN 1.0/2.3 Female
Temp Range	-65 to +85°C
Mating Cycles	500

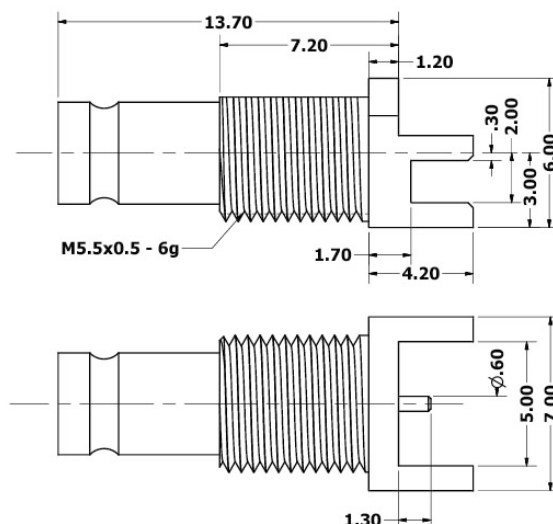
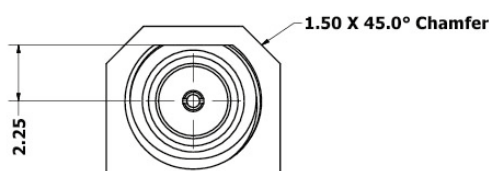

Return Loss Graph

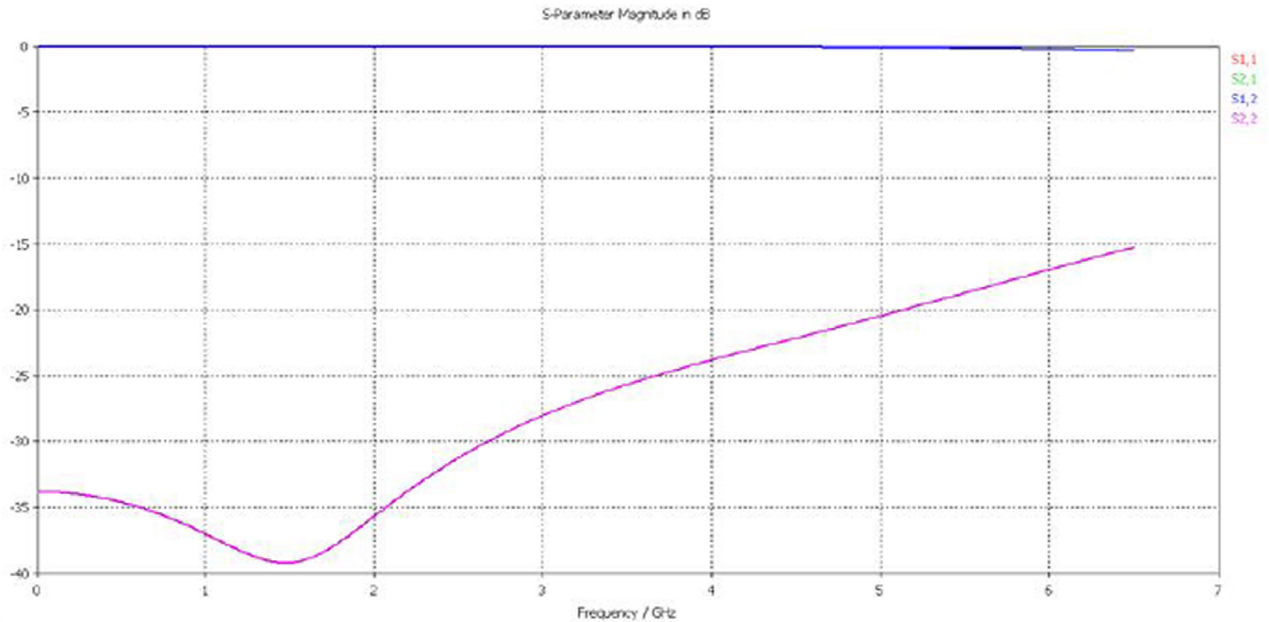

PCB Layout

