

Specifications:  
Current Rating: 4A (2~5P); 2A (6~8P); 1.5A(9~12P) AC/DC  
Voltage Rating: 250V (2~4P); 60V (5P); 30V (6~12P) AC/DC  
Contact Resistance: 5m ohm Max.  
Insulation Resistance: 100M ohm Min.  
Withstanding Voltage: 500V AC/Minute  
Operating Temperature Range: -40°C ~ +100°C  
Waterproof Rate: IP67

CC12-XXP-FA-PBSX  
Panel Lock Thread: PG9 or M16  
With Shielding  
Panel Mount PCB Dip  
Front Fastened Coding: A  
Plug  
No. of Contacts  
M12

Pin Assignments Front View

2Pin	3Pin	4Pin	5Pin	6Pin	7Pin
8Pin	9Pin	10Pin	11Pin	12Pin	

Item	Description	Material	Remark	Q'TY
1	Insulator	Nylon 66	UL94V-0 Black	1
2	Terminal	Copper Alloy	Gold Plated 3u"	2~12
3	Shell	Copper Alloy	Nickel Plated 60u"	1
4	Seal ring	Silicone	Red	1
5	Nut	Copper Alloy	PG9 or M16 Nickel Plated 60u"	1

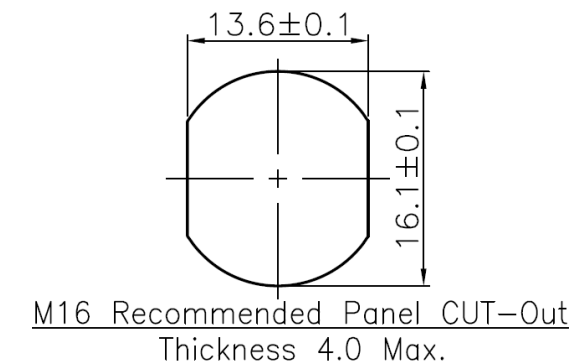
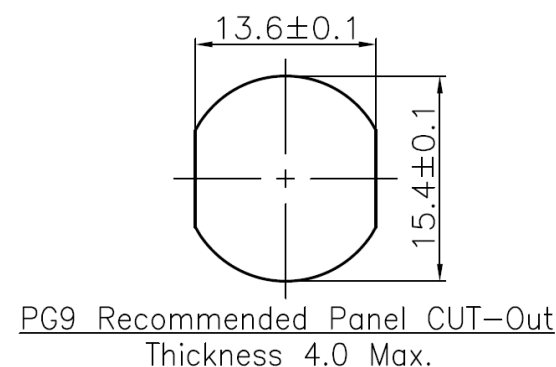

REVISION HISTORY				
REV	DESCRIPTION	CHG REF	DATE	DESIGNER
1.0	Origin	-	22 08 2023	Name

DO NOT SCALE			Designed by Owen Page	X.X - +-0.30 X.XX - +-0.20	Design Right Protected	©2023	Date 22 08 2023	A4
Unit of Measure: millimetres (mm)								
<div>RoHS Compliant</div>	<div>Cambridge Electronic Industries Ltd</div>	<div>This document and all the data contained herein is and shall remain the property of Cambridge Electronic Industries Ltd and may not be used or copied for any purpose whatsoever without the written permission of Cambridge Electronic Industries Ltd</div>	Description: M12 A Code Plug With Shielding Straight Dip Type					
			<div>Part No: CC12-XXP-FA-PBSX</div>					

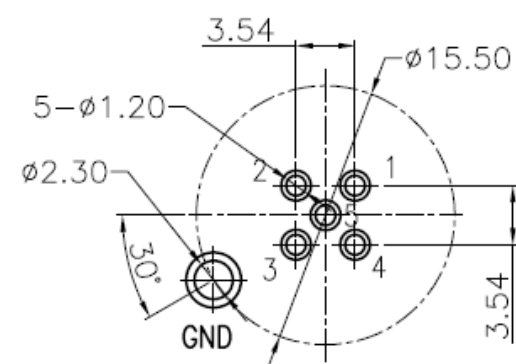

3~5P Recommended PCB Layout  
TOL:±0.05mm

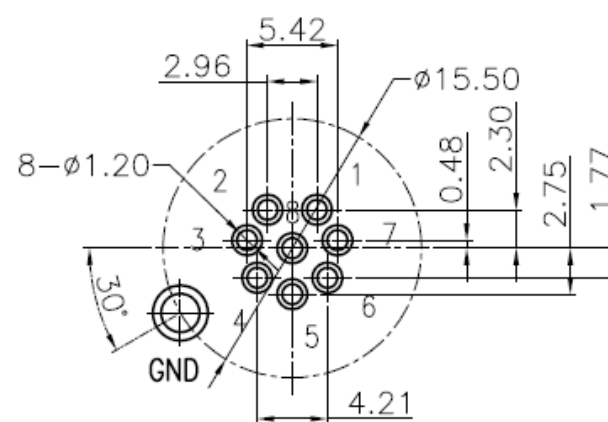

6~8P Recommended PCB Layout  
TOL:±0.05mm

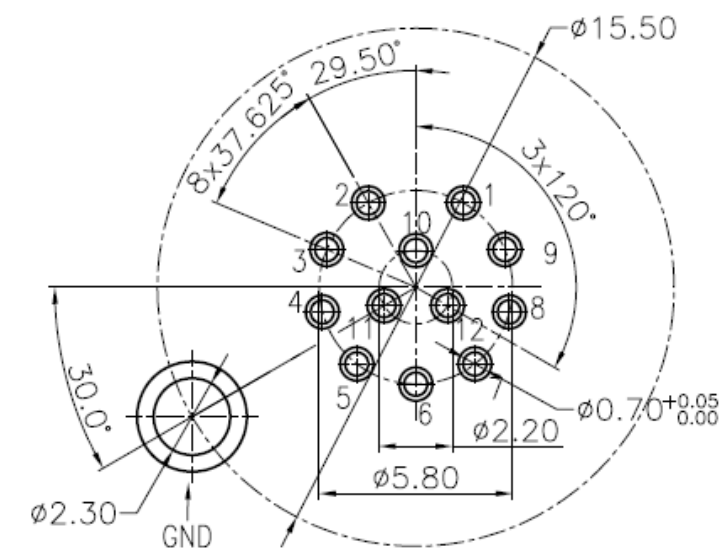

9~12P Recommended PCB Layout  
TOL:±0.05mm  
Scale:2:1

REVISION HISTORY				
REV	DESCRIPTION	CHG REF	DATE	DESIGNER
1.0	Origin	-	23 08 2023	Owen Page

DO NOT SCALE	Third Angle Projection
Unit of Measure: millimetres (mm)	

Designed by  
Owen Page

X.X - +0.30  
X.XX - +0.20

**Design Right  
Protected**

©2023

Date  
Owen Page

A4

**RoHS  
Compliant**

**Cambridge  
Electronic  
Industries Ltd**

This document and all the data  
contained herein is and shall remain  
the property of Cambridge Electronic  
Industries Ltd and may not be used  
or copied for any purpose  
whatsoever without the written  
permission of Cambridge Electronic  
Industries Ltd.

Description:

M12 A Code Plug With Shielding Straight Dip Type

Part No:  
CC12-XXP-FA-PBSX

Issue  
1.0

Sheet  
2 / 3

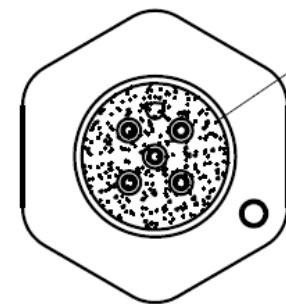
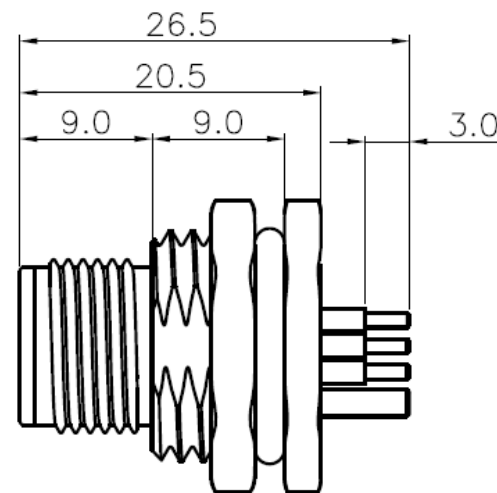
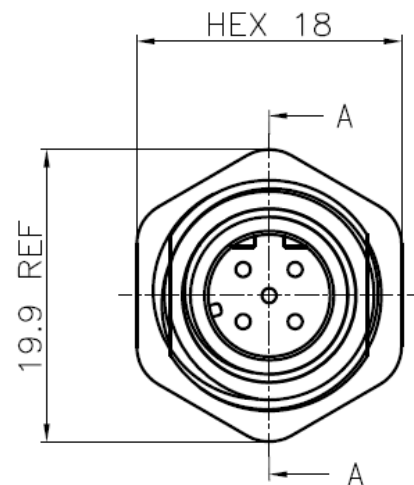

Specifications:  
Current Rating: 4A AC/DC  
Voltage Rating: 250V (3~4P); 60V (5P) AC/DC  
Contact Resistance: 5m ohm Max.  
Insulation Resistance: 100M ohm Min.  
Withstanding Voltage: 500V AC/Minute  
Operating Temperature Range: -40°C ~ +100°C  
Waterproof Rate: IP67

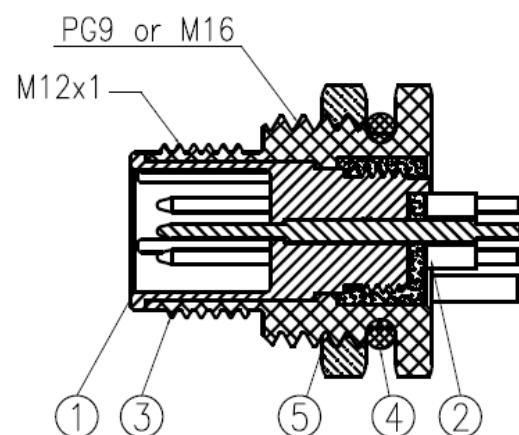

Section A-A

CC12-XXP-FD-PBSX  
Panel Lock Thread: PG9 or M16  
With Shielding  
Panel Mount PCB Dip  
Front Fastened Coding: D  
Plug  
No. of Contacts  
M12

Pin Assignments Front View

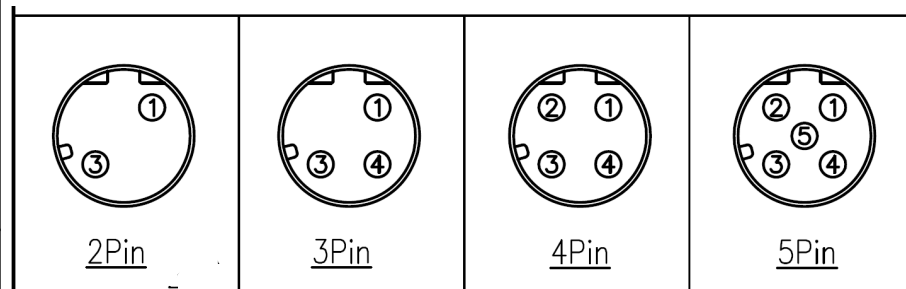

ITEM	Description	Material	Remark	Q'TY
1	Insulator	Nylon	UL94V-0 Black	1
2	Terminal	Copper Alloy	Gold Plated 3u"	2~5
3	Shell	Copper Alloy	Nickel Plated 60u"	1
4	Seal ring	Silicone	Red	1
5	Nut	Copper Alloy	PG9 or M16 Nickel Plated 60u"	1

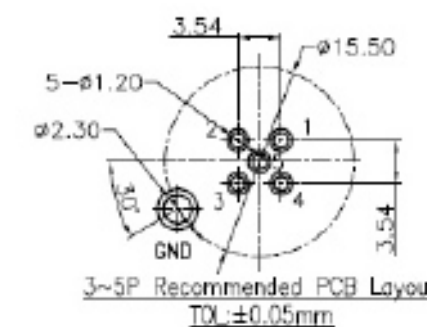

REVISION HISTORY				
REV	DESCRIPTION	CHG REF	DATE	DESIGNER
1.0	Origin	-	22 08 2023	Owen Page

DO NOT SCALE  
Unit of Measure: millimetres (mm)

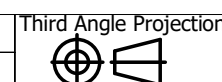

Designed by  
Owen Page

X.X - +0.30  
X.XX - +0.20

Design Right  
Protected

©2023

Date  
22 08 2023

A4

**RoHS  
Compliant**

**Cambridge  
Electronic  
Industries Ltd**

This document and all the data contained herein is and shall remain the property of Cambridge Electronic Industries Ltd and may not be used or copied for any purpose whatsoever without the written permission of Cambridge Electronic Industries Ltd.

Description:  
M12 D Code Plug With Shielding Straight Dip Type  
Part No:  
CC12-XXP-FD-PBSX

Issue  
1.0

Sheet  
3 / 3