

### General Description

The CC16-XXP-FA-PMX is a M16 circular plug connector which is available with 2 to 14 pin options in an A coding. The connector is front fastening panel mounted and features solder buckets to the rear for mounting on cable. The connector can be purchased as a single connector or as part as a standard cable assembly (part number SCA16-XXPFAX-XXXX) or a bespoke cable assembly with different termination options.

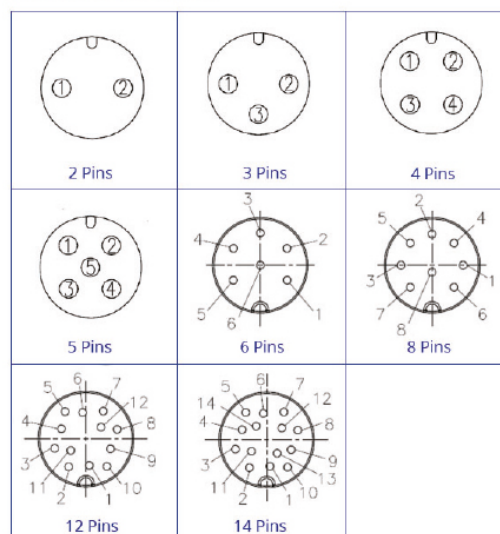

Pin Assignments Front View



CC16-XXP-FA-PMX

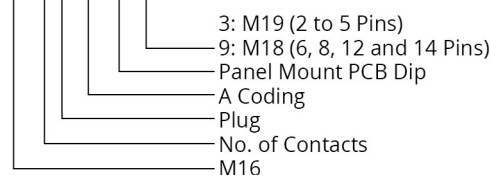

Specification	
Coding	A
Contact	2, 3, 4, 5, 6, 8, 12 and 14 Pins
Current Rating	10A AC/DC (2 to 5 Pins) 5A AC/DC (6 to 8 Pins) 3A AC/DC (12 to 14 Pins)
Voltage Rating	60V AC/DC
Contact Resistance	≤5mΩ
Insulation Resistance	≥100MΩ
Withstanding Voltage	500V AC/Minute
Operating Temperature	-40°C to +100°C
Waterproof Rating	IP68
Material Plating	
Insulator	Nylon UL94V-0 Black
Connector Contacts	Brass Gold Plated
Shell	Brass Nickel Plated
Seal Ring	Red Silicone
Nut	Brass Nickel Plated

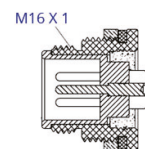
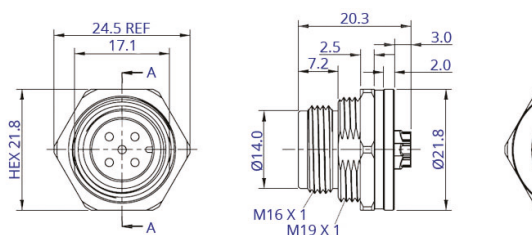

Section A-A

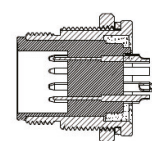
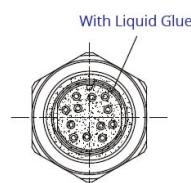
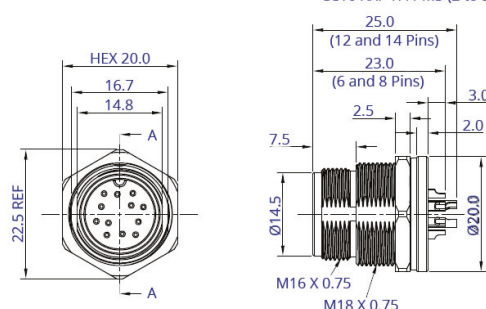

Section A-A

Drawing Issue 1.0