

General Description

The XBS-06-RB22-NNV precision is a bulkhead mounting BNC connector which can be used in PCI® Express applications. It features a Pathfinder™ light pipe which aids port identification and status. The connector has a shorter leg length of 2.2mm. It also has a built in flange which provides additional EMI shielding and is optimised for 6G HD-SDI environments.

This connector was formerly sold as:
C-SX-156 as a connector only product



Electrical

Impedance		75Ω
Frequency Range		0-6GHz
Working Voltage		500Vrms
Reflection Factor (VSWR)		1.16 (max) 0-3GHz 1.49 (max) 3-6GHz
Dielectric Withstanding Voltage		1500Vrms
Insulation Resistance		≥5000MΩ
Contact Resistance	Centre Contact	≤ 1.5mΩ
	Outer Contact	≤ 1.0mΩ



Materials

Centre Pin	PhosBronze / 10 μ"Au
Metal Parts	Die Cast Zinc/Ni
Insulators	UL94 HB TPX

Environmental

Connector Type	BNC Female
Temp Range	-65 to +85°C
Mating Cycles	500

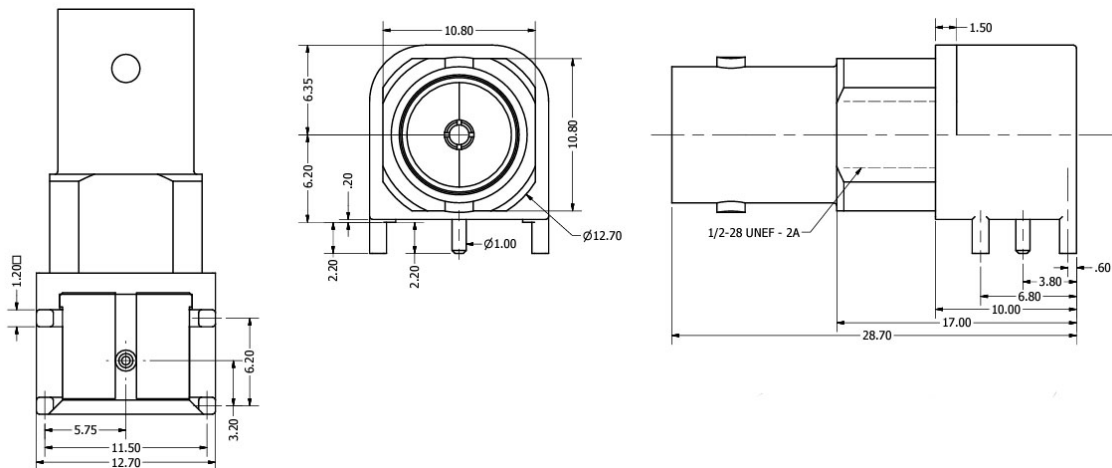

Return Loss Graph

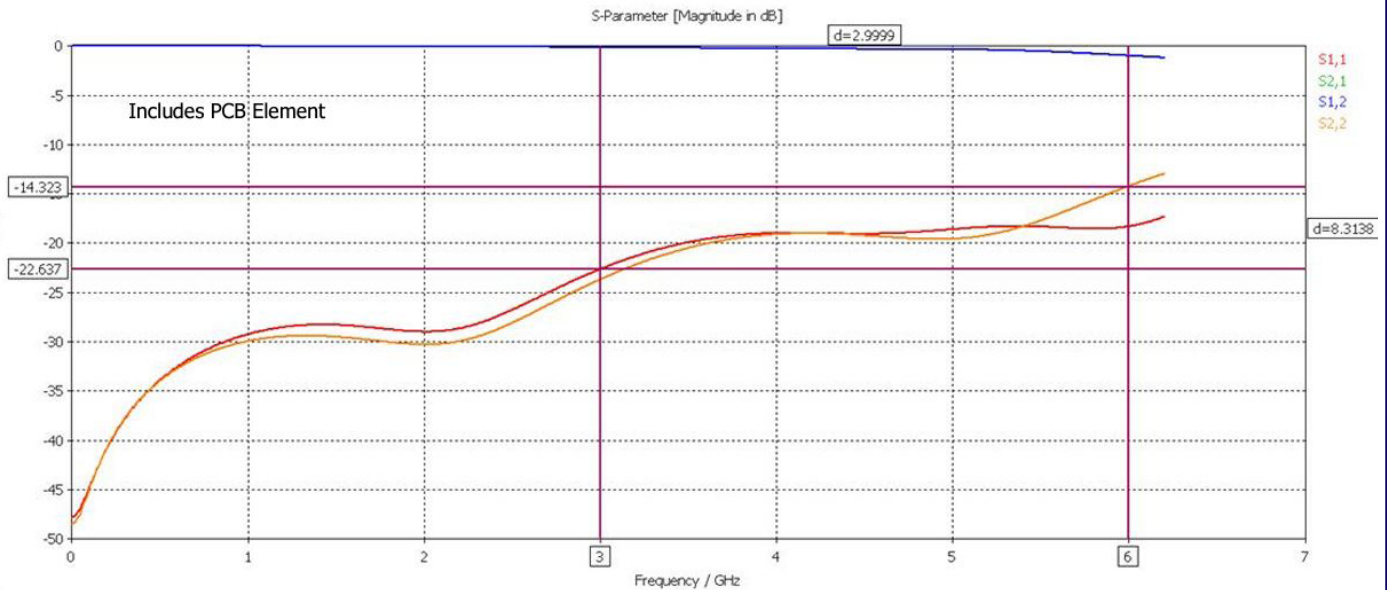

PCB Layout and Panel Cutout

